

1. LAYOUT DRAWING

Document No.

YJAT-800L-AM

Rev.

0

Page

-

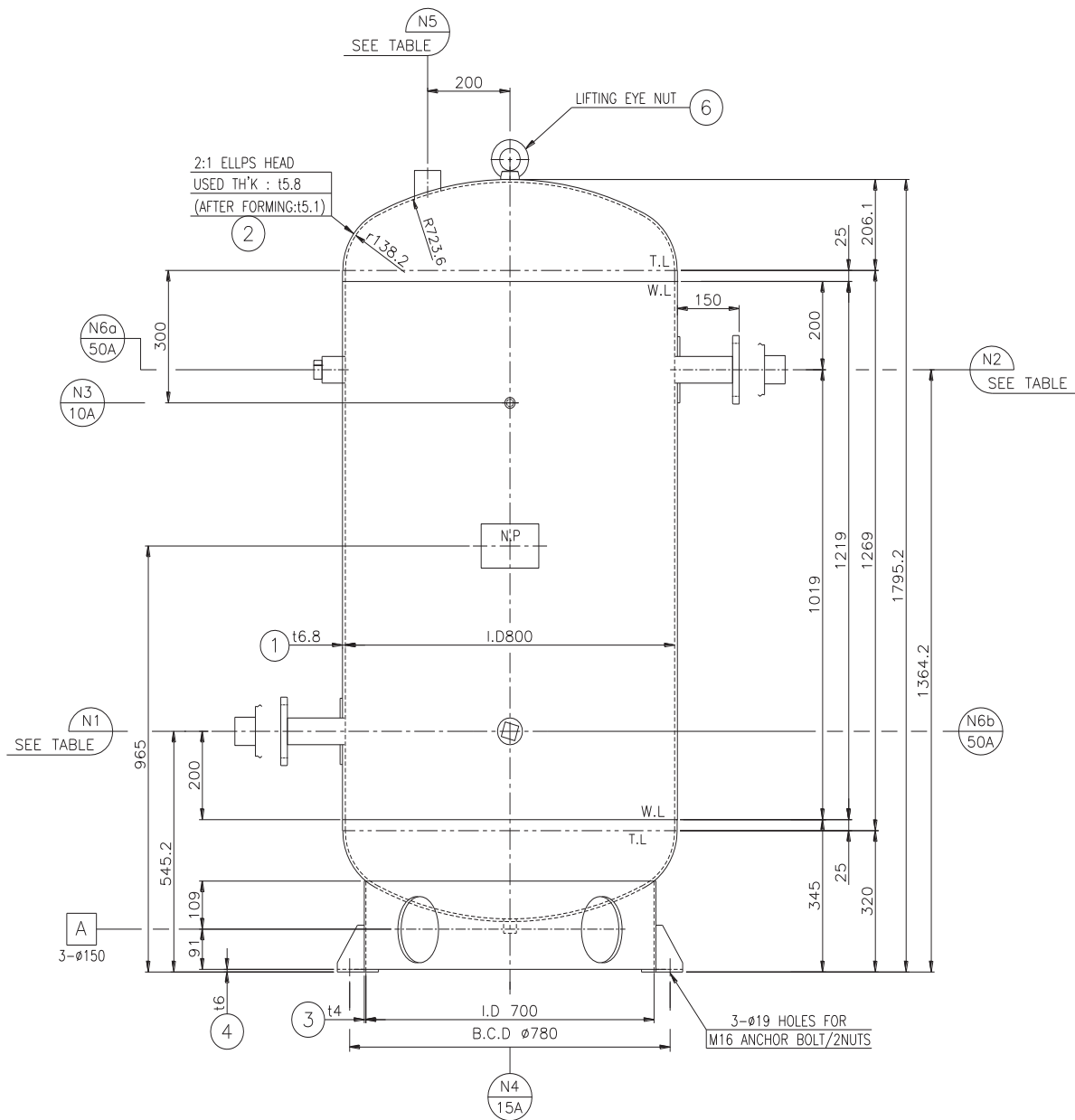

2. DESIGN CONDITION (설계조건)	Document No.	Rev.	Page
	YJAT-800L-AM	0	-

VOLUME : 0.8 m³

No.	DESCRIPTION	DESIGN DATA	참고사항
1	APPLICATION CODE(적용규격 코드)	ASME SEC.VIII, DIV.1	
2	VESSEL TYPE(압력용기 타입)	VERTICAL	
3	FLUID(사용유체)	AIR or N ₂	
4	DESIGN PRESSURE(설계압력)	INTERNAL	0.98 Mpa
		EXTERNAL	0 Mpa
5	OPER. PRESSURE(사용압력)	0.88 Mpa	
6	DESIGN TEMPERATURE(설계온도)	INTERNAL	100 °C
		EXTERNAL	- °C
7	OPER. TEMPERATURE(사용온도)	INTERNAL	AMB. °C
8	HYDRO. TEST PRESSURE(수압시험 압력)	1.274 Mpa	
9	PNEU. TEST PRESSURE(공기압시험 압력)	N.A Mpa	
10	HEAD TYPE (경판형상)	2 : 1 ELLIPSOIDAL HEAD	
11	RADIOGRAPHIC EXAMINATION 비파괴 검사	SHELL : E1	LONGITU'L JOINT NO
		SHELL : E2	CIRCUM'L JOINT NO
		HEAD	N.A
12	JOINT EFFICIENCY (용접 효율)	SHELL : E1	LONGITU'L JOINT 0.70
		SHELL : E2	CIRCUM'L JOINT 0.65
		HEAD	0.85
13	PWHT [S / H/ H (S.R 처리)] (후열처리)	N.A / N.A / N.A	* S.R 처리 : Stress Reallies
	IMPACT & THERMAL LOAD, ETC	N/A	
14	CORROSION ALLOWANCE(부식여유)	1.0 mm	
15	SHELL INSIDE DIAMETER(동체내경)	800 mm	
16	M. A. W. P.	NEW & COLD	-
		HOT & CORR.	-
17	LOCATION	INDOOR / OUTDOOR	
18	WEIGHT(무게)	ERECTION	275 Kg
		OPERATING(사용)	275 Kg
		FULL WATER(수압)	1076 Kg
19	MATERIAL (재질)		
	- SHELL	SS400	114 N/mm ²
	- HEAD	SS400	114 N/mm ²
	- NOZZLE PIPE	SPP(E)	61 N/mm ²
	- NOZZLE FLANGE	SS400	114 N/mm ²
	- SUPPORT	SS400	114 N/mm ²
	- EXT. BOLT /NUT	SNB7/S45C	130 / 122 N/mm ²
	- LIFTING LUG	SS400	114 N/mm ²
- GASKET	NON-ASBESTOS	-	

HYDRO. TEST PRESSURE: P x 1.3 x $\frac{114}{114}$ = 1.274 Mpa